

# SUN SCALE



## CH Load Cell

- **Stainless Steel** construction
- Capacities from 10k to 200k pounds
- 2 mv/v output
- Hermetically Sealed IP 68
- Interchangeable to most brands

### SPECIFICATIONS

Rated Capacities (pounds)	10k, 25k, 50k, 65k, 100k, 130k, 200k
Combined Error (% of R.O.)	0.1
Non-Repeatability (% of R.O.)	0.015
Minimum Division Size (v min., % of R.O.)	0.015
Temperature Coefficient	
Output (ppm/ °C, of load)	15
Zero (ppm/ °C, of R.O.)	30
Creep Return (% of load, 30 Min.)	0.025
Rated Output (mv/v)	2 ± 0.25%
Zero Balance (% of R.O.)	± 2
Excitation (Volt)	10 recommended, 15 Max.
Input Impedance (Ω)	450 ± 1%
Output Impedance (Ω)	480 ± 1%
Operating Temperature Range ( °C )	-40 to +60
Environmental Protection (DIN)	IP 68
Safe Overload (% of R.O.)	150

Example for Order Number: **CH-50k**, CH: load cell type, **50k**: capacity in pounds (50,000 lbs)

### DIMENSIONS

Wiring Code:  
 +Input Red  
 - Input Black  
 +Output Green  
 - Output White

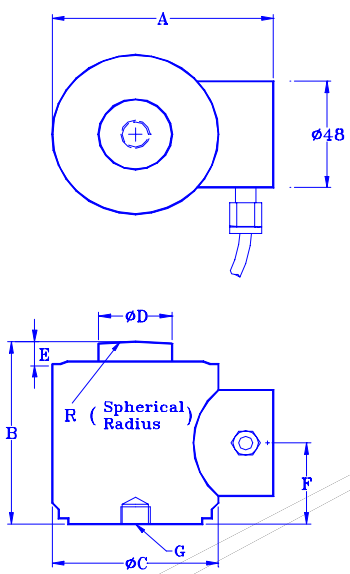

Pounds & Inches  
(Ton & mm)

CAPACITY	A	B	C	D	E	F	G	R
10k ~ 65k (4.5 ~ 29.5)	3.78 (96)	3.25 (82.6)	ø2.83 (ø72)	ø1.25 (ø31.7)	0.40 (10.2)	1.46 (37)	1/2-20 UNF,Deep 0.31 (8)	6 (152)
100k, 130k (45.4, 59.1)	5 (127)	5 (127)	ø3.94 (ø100)	ø2.31 (ø58.6)	0.52 (13.1)	2.05 (52)	3/4-16 UNF,Deep 0.55 (14)	10 (254)
200k (90.7)	6.34 (161)	7.25 (184)	ø5.20 (ø132)	ø3.13 (ø79.5)	1.07 (27.2)	3.03 (77)	3/4-16 UNF,Deep 0.75 (19)	17 (432)

4-Wire, ø5 Cable, 40Feet (12Meter)